

Y:\SHARED\CA\FREDERICTON\WORK\24\2402844 - PICTOU\CALADH AVE\CADD\DESIGN\CURRENT SHEETS\2402844 - 1D - C01.DWG, 16/01/2025 11:24 AM



NO.	DATE	REVISIONS	BY	APPR.
0	2025-01-17	ISSUED FOR 75% REVIEW	AB	GM



PROJECT TITLE		MARKET STREET & CALADH AVENUE RECONSTRUCTION	
PICTOU DRAWING TITLE		EXISTING CONDITIONS AND REMOVALS PLAN	
Scale	Drawn By	Design By	
	AB	AB	
	Checked By	Cadd Check	
	GM	JP	
	Sheet		1 of 6
File Name	2402844 -1D - C01.DWG		
Drawing No.	C01		

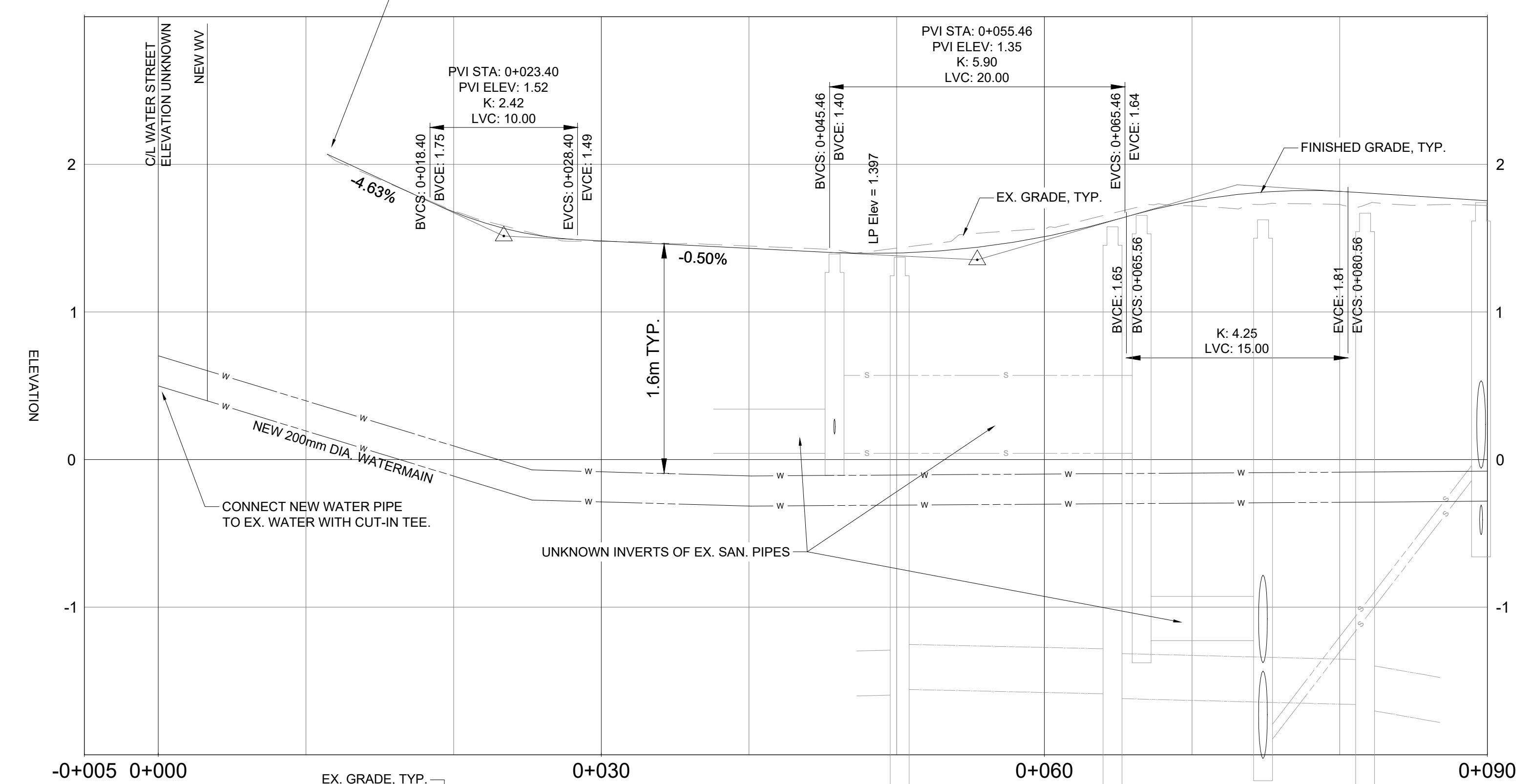
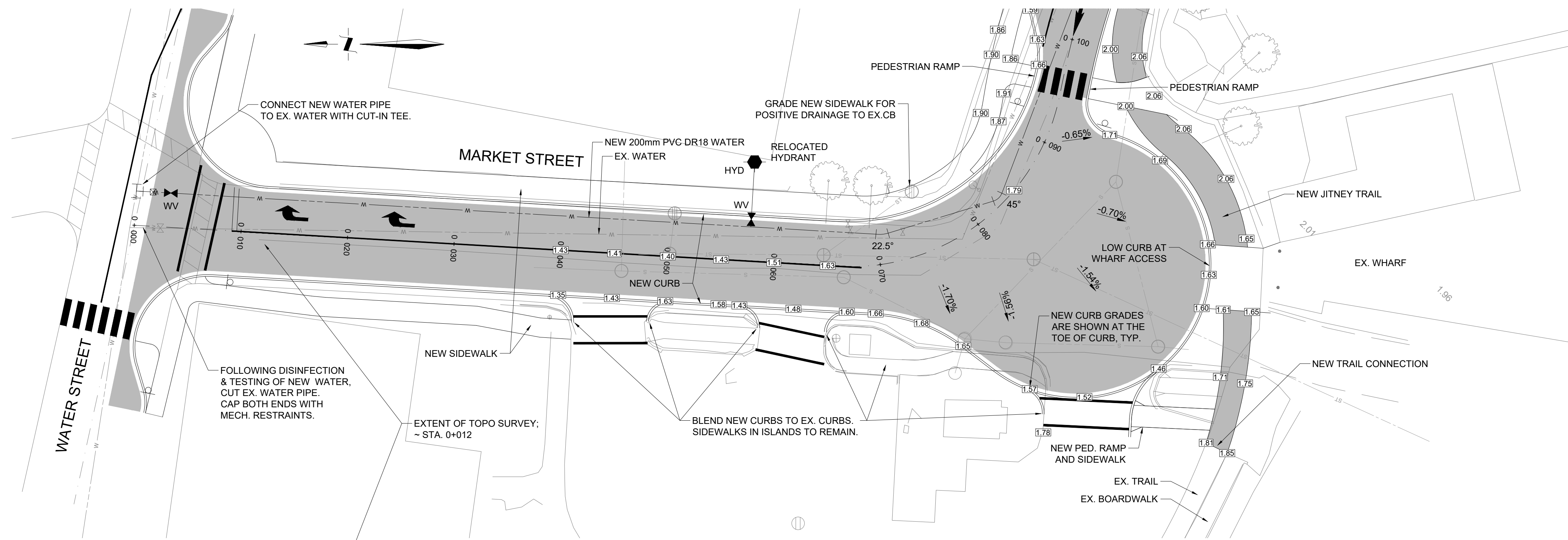

EX. GRADE, TYP.	1.69	1.68	1.48	1.48	1.45	1.43	1.43	1.40	1.57	1.51	1.72	1.75	1.73	1.82	1.72	1.75
FIN. GRADE, TYP.																

Sanitary Sewer Data:				0+045.794 TOP=1.39		0+066.590 TOP=1.65	0+074.808 TOP=1.63	9.40% 20.492 Start Elev: -1.98 End Elev: -0.06	0+089.578 TOP=1.74
Storm Sewer Data:	0+050.208 TOP=1.37	0.22% 14.432 Start Elev: -1.56 End Elev: -1.59	0+064.823 TOP=1.58	0.22% 19.670 Start Elev: -1.62 End Elev: -1.66	0+081.719 TOP=1.67	0.22% 40.801 Start Elev: -1.69 End Elev: -1.78			

- NOTE:
- LOCATION AND CONDITION OF EXISTING WATER IS UNKNOWN.
  - NEW WATER SHALL BE 200mm DIA. PVC DR18.
  - ALL BENDS AND END CAPS TO INCLUDE CONCRETE THRUST BLOCKS.
  - FOLLOWING INSTALL OF NEW WATER, EX. WATER SHALL BE FILLED WITH SLURRY AND ABANDONED IN PLACE.
  - SOME SANITARY MANHOLES WERE FULL AT THE TIME OF THE INTRUSIVE SURVEY AND INVERTS ARE UNKNOWN.
  - PIPE MATERIALS FOR BOTH STORM AND SANITARY VARY BETWEEN PVC AND CONCRETE.
  - EXISTING STORM AND SANITARY INFRASTRUCTURE TO REMAIN UNLESS OTHERWISE NOTED.
  - DESIGN DETAILS TO FOLLOW HALIFAX REGIONAL MUNICIPALITY AND HALIFAX WATER SPECIFICATIONS; LISTED ON SHEET C06.



0	2025-01-17	ISSUED FOR 75% REVIEW	AB	GM
NO.	DATE	REVISIONS	BY	APPR.



PROJECT TITLE  
**MARKET STREET & CALADH AVENUE RECONSTRUCTION**

PICTOU DRAWING TITLE  
**MARKET STREET PLAN AND PROFILE**

Scale	Drawn By	Design By
2.5m 0 5m (1:250 FULL SCALE)	AB	AB
	Checked By	Cadd Check
	GM	JP
	Sheet	2 of 6

File Name  
2402844 -1D - C01.DWG

Drawing No.  
**C02**

Y:\SHARED\CA\FREDERICTON\FWORK\2024\2402844 - PICTOU\CALADH AVENUE\CADD\DESIGN\CURRENT SHEETS\2402844 -1D - C01.DWG, 16/01/2025 11:24 AM



Y:\SHARED\CAD\FREDERICKSON\WORK\2402844-1D-C01.DWG - PICTOU\CALADH AVE\CADD\DESIGN\CURRENT SHEETS\2402844-1D-C01.DWG, 16/01/2025 11:25 AM

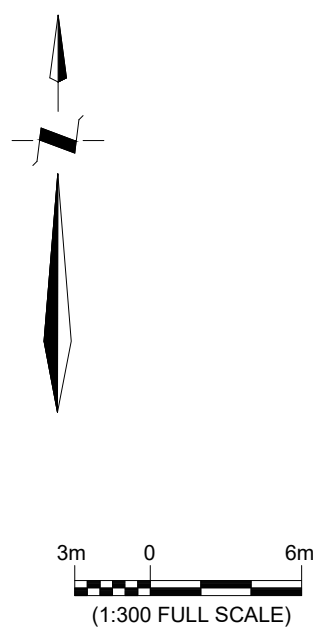
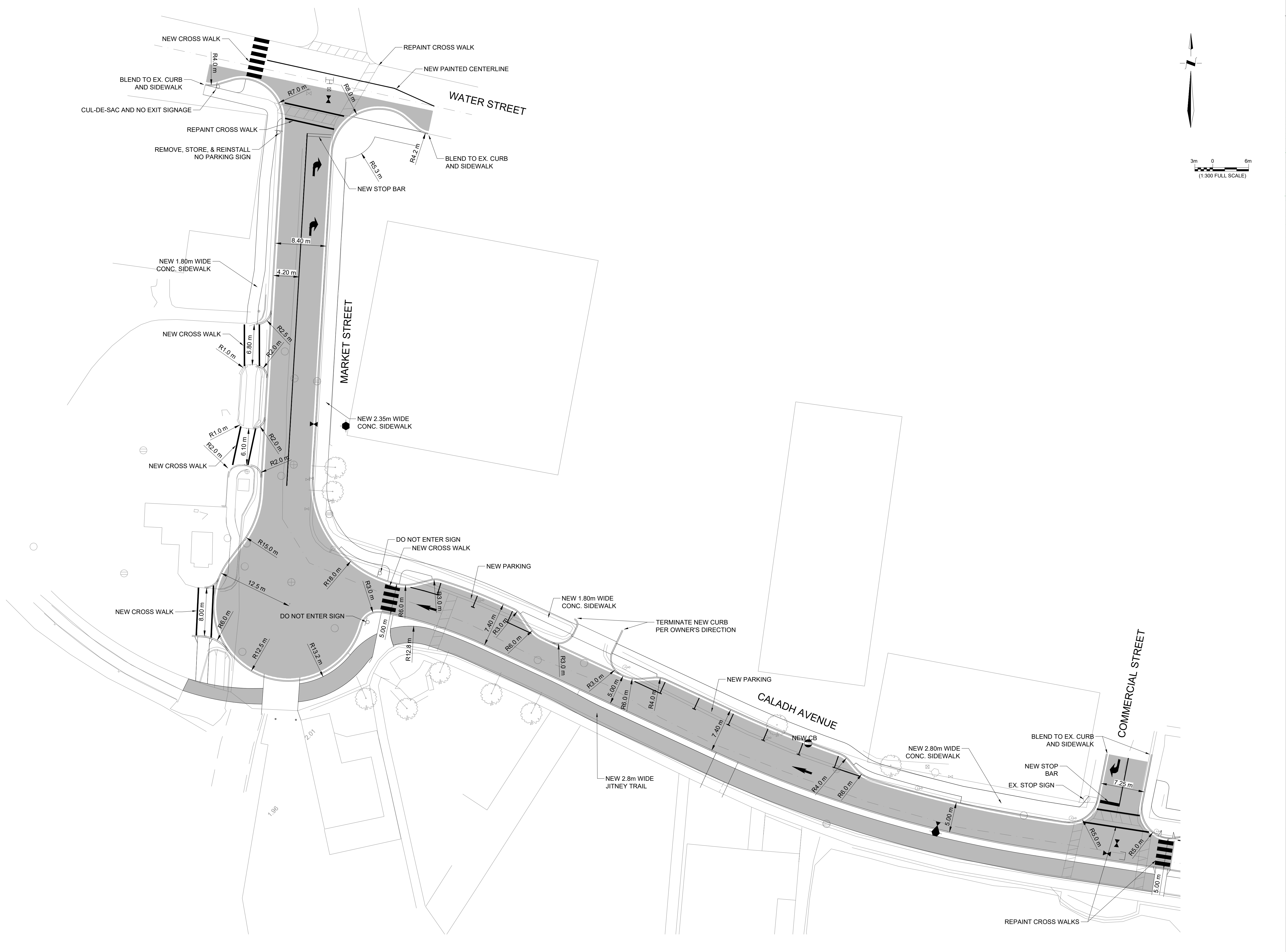

NO.	DATE	REVISIONS	BY	APPR.
0	2025-01-17	ISSUED FOR 75% REVIEW	AB	GM



PROJECT TITLE  
**MARKET STREET & CALADH AVENUE RECONSTRUCTION**

PICTOU DRAWING TITLE  
NS

**PAVEMENT MARKINGS, SIGNAGE, AND GEOMETRY PLAN**

Scale 	Drawn By AB	Design By AB
	Checked By GM	Cadd Check JP
	Sheet 4 of 6	

File Name  
2402844 -1D - C01.DWG

Drawing No.  
**C04**

Y:\SHARED\CAD\FREDERICTON\WORK\2402844-1D - C01.DWG, 16/01/2025 11:25 AM

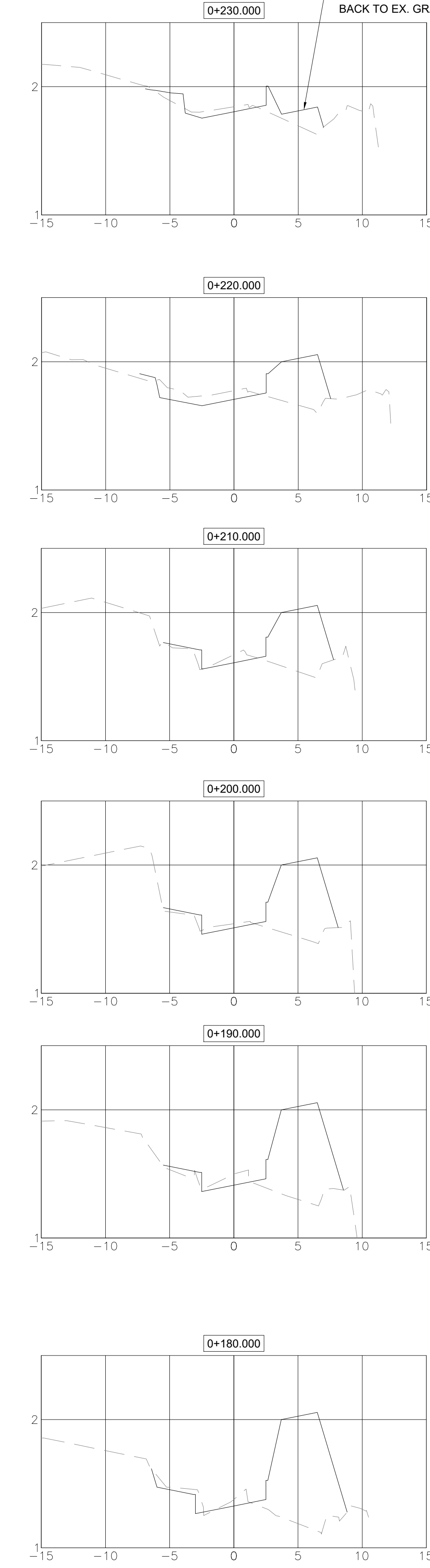
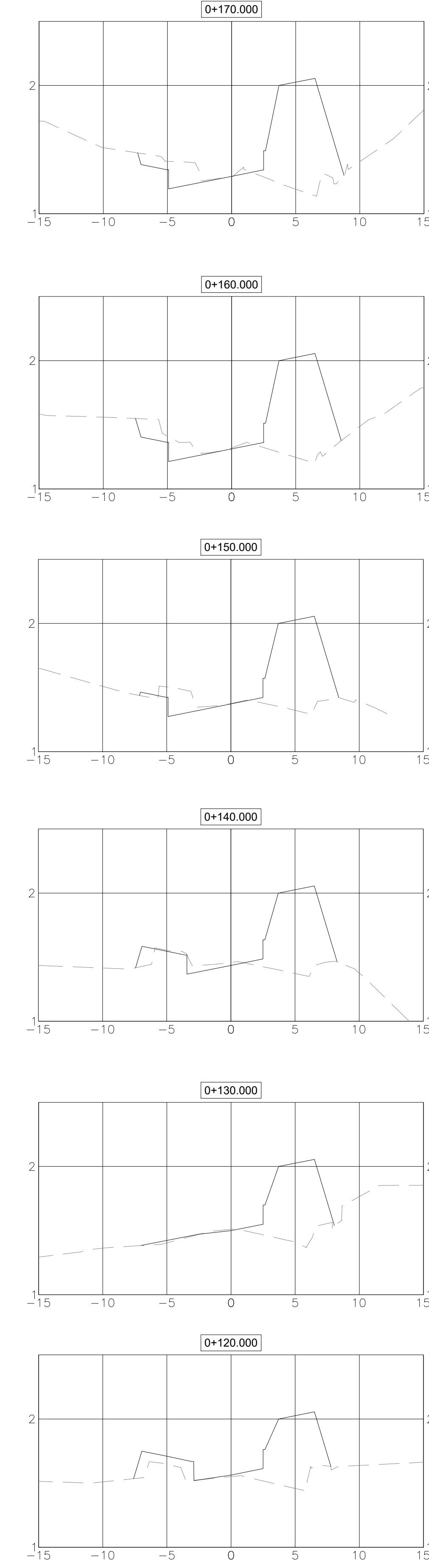
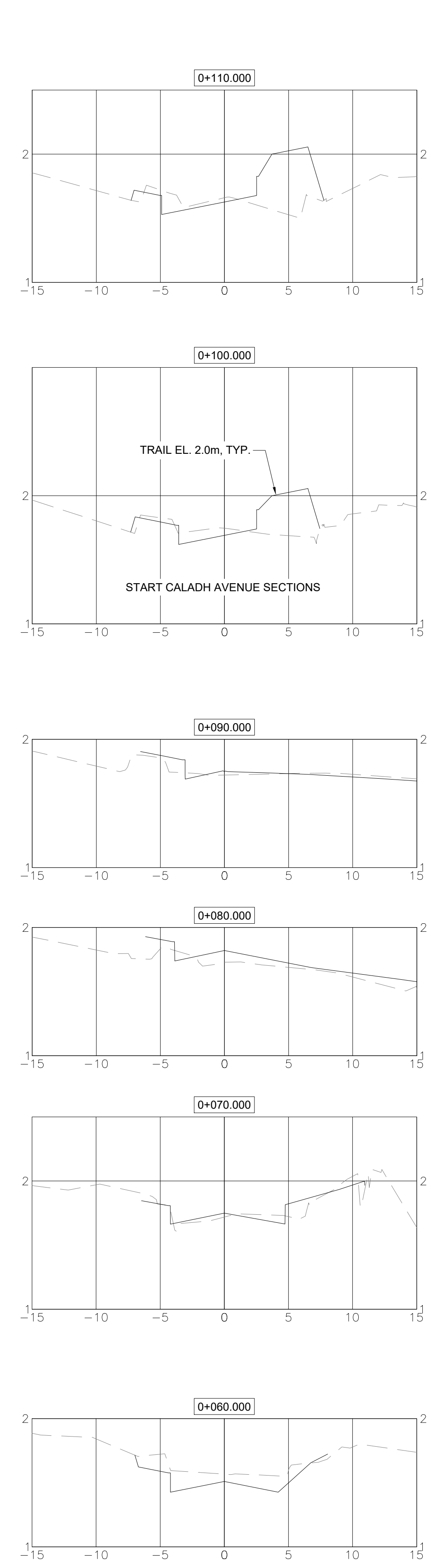
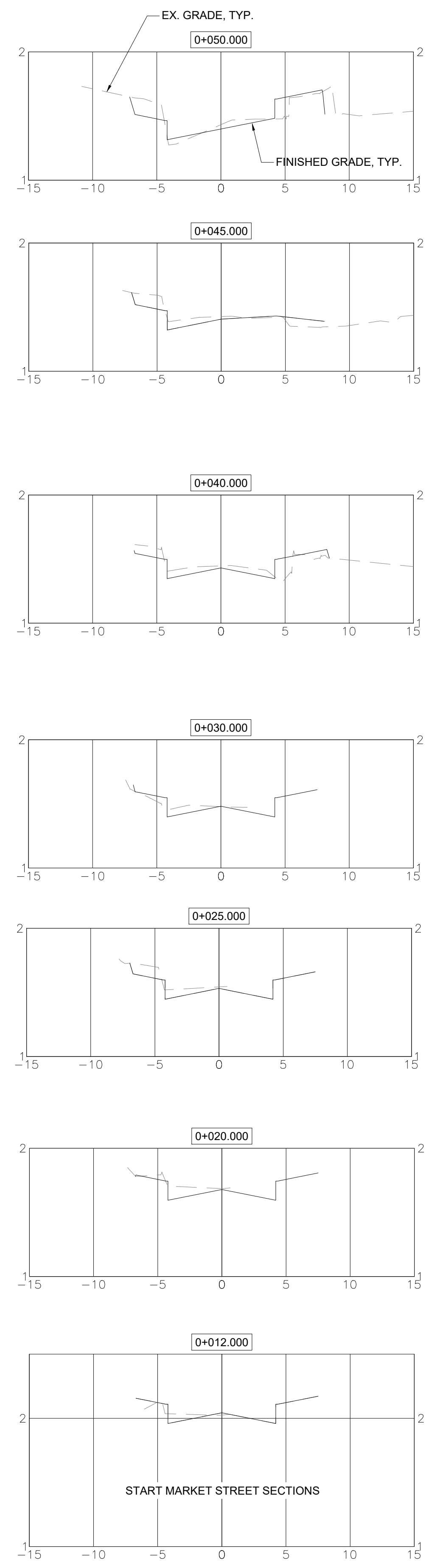

NO.	DATE	REVISIONS	BY	APPR.
0	2025-01-17	ISSUED FOR 75% REVIEW	AB	GM



PROJECT TITLE  
**MARKET STREET & CALADH AVENUE RECONSTRUCTION**

PICTOU DRAWING TITLE NS

**CROSS SECTIONS**

Scale  1:250 HORIZ. (1:25 VERT.)	Drawn By <b>AB</b>	Design By <b>AB</b>
	Checked By <b>GM</b>	Cadd Check <b>JP</b>
	Sheet <b>5</b> of <b>6</b>	

File Name: 2402844 -1D - C01.DWG

Drawing No. **C05**

**GENERAL NOTES**

- ELEVATIONS ARE IN METERS AND ARE GEODETIC.
- ALL WORK TO BE IN ACCORDANCE WITH CONSTRUCTION DOCUMENTS AND THE STANDARD SPECIFICATION FOR MUNICIPAL SERVICES (SSMS), LATEST EDITION.
- LOCATION OF EXISTING WATER AND SEWER MAINS SHOWN ON THE DRAWINGS IS APPROXIMATE. CONTRACTOR TO CONFIRM AND ADVISE THE PROJECT ENGINEER OF ANY DISCREPANCIES DURING EXCAVATION.
- SAFETY SIGNS TO BE INSTALLED PRIOR TO THE START OF CONSTRUCTION AND IN ACCORDANCE WITH THE NSTIR WORK AREA TRAFFIC CONTROL MANUAL.
- MANHOLES COVERS TO BE ADJUSTED TO SUIT THE NEW FINISHED GRADES.
- ALL BENDS, TEES, CAPS, REDUCERS AND HYDRANT VALVES ARE TO BE COMPLETE WITH MECHANICAL RESTRAINERS.
- CONTRACTOR IS RESPONSIBLE FOR TEMPORARY SUPPORT OF HYDRO POLES DURING INSTALLATION OF WATER MAIN AND SEWERS AS REQUIRED, INCIDENTAL TO THE WORK.
- THE CONTRACTOR WILL BE RESPONSIBLE FOR ANY DAMAGE TO EXISTING UTILITIES.
- CONTRACTOR IS RESPONSIBLE FOR DUST CONTROL AND STREET GRAVEL MAINTENANCE AND REGRADING SITE FOR THE ENTIRE DURATION OF THE WORK.
- ALL DISTURBED AREAS SHALL BE REINSTATED TO PREVIOUS CONDITIONS OR BETTER.
- ALL WORK IS TO BE IN ACCORDANCE WITH REQUIREMENTS OF ALL FEDERAL, PROVINCIAL, AND MUNICIPAL PERMITS AND REGULATIONS.
- CONTRACTOR IS TO NOTIFY THE REGULATORS, ENGINEER AND THE MUNICIPALITY BEFORE COMMENCING CONSTRUCTION.
- CONTRACTOR IS RESPONSIBLE FOR PROTECTION OF ALL NATURAL FEATURES AND ALL SEDIMENT LADEN RUNOFF FROM THE CONSTRUCTION SITE. ACCEPTABLE PROCEDURES ARE AVAILABLE FROM THE NS ENVIRONMENT DOCUMENT "EROSION AND SEDIMENTATION CONTROL HANDBOOK FOR CONSTRUCTION SITES"
- ALL DISTURBED AREAS NOT STABILIZED BY GRAVEL, SOD, ASPHALT OR CONCRETE SHALL BE STABILIZED WITH 100MM OF TOPSOIL AND HYDROSEED.
- MATERIALS MAY NOT BE SUBSTITUTED UNLESS PERMITTED BY THE ENGINEER.
- SHOP DRAWINGS TO BE SUBMITTED FOR REVIEW BY THE ENGINEER.
- LOCATION OF EXISTING INFRASTRUCTURE IS BASED ON THE BEST AVAILABLE INFORMATION AND IS SUBJECT TO CONFIRMATION. IF THE CONTRACTOR IDENTIFIES ANY DISCREPANCIES NOTIFY THE ENGINEER IMMEDIATELY.
- CONTRACTOR TO ACQUIRE ALL NECESSARY PERMITS TO PERFORM WORK AND TO COMPLY WITH ALL PERMIT REQUIREMENTS AND CONDITIONS.
- CONTRACTOR RESPONSIBLE FOR ALL TRAFFIC CONTROL MEASURES REQUIRED FOR THE PROJECT. ALL TEMPORARY TRAFFIC CONTROL MEASURES TO BE IN ACCORDANCE WITH THE LATEST EDITION OF THE NOVA SCOTIA TRANSPORTATION AND INFRASTRUCTURE RENEWAL TEMPORARY WORKPLACE TRAFFIC CONTROL MANUAL AND THE LATEST EDITION OF THE TRANSPORTATION ASSOCIATION OF CANADA MANUAL OF UNIFORM TRAFFIC CONTROL DEVICES FOR CANADA.

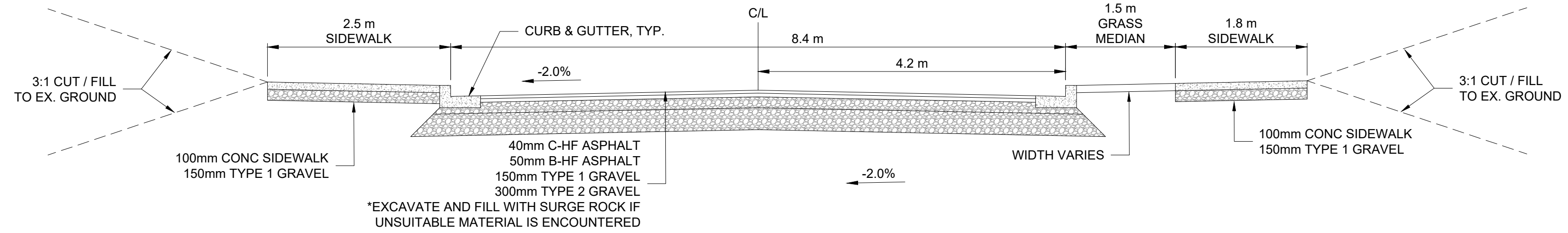

**TYPICAL ROAD SECTION - MARKET STREET**

SCALE: 1:50

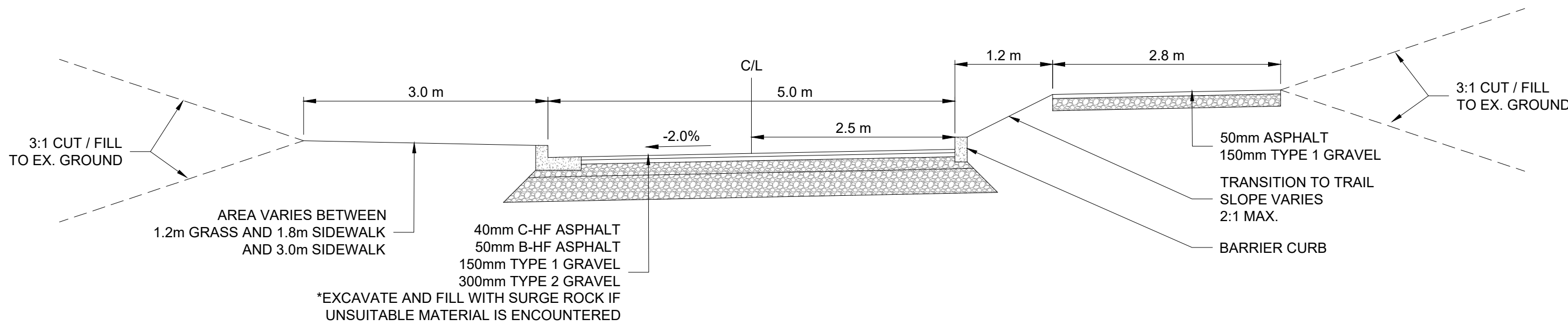

**TYPICAL ROAD SECTION - CALADH AVENUE**

SCALE: 1:50

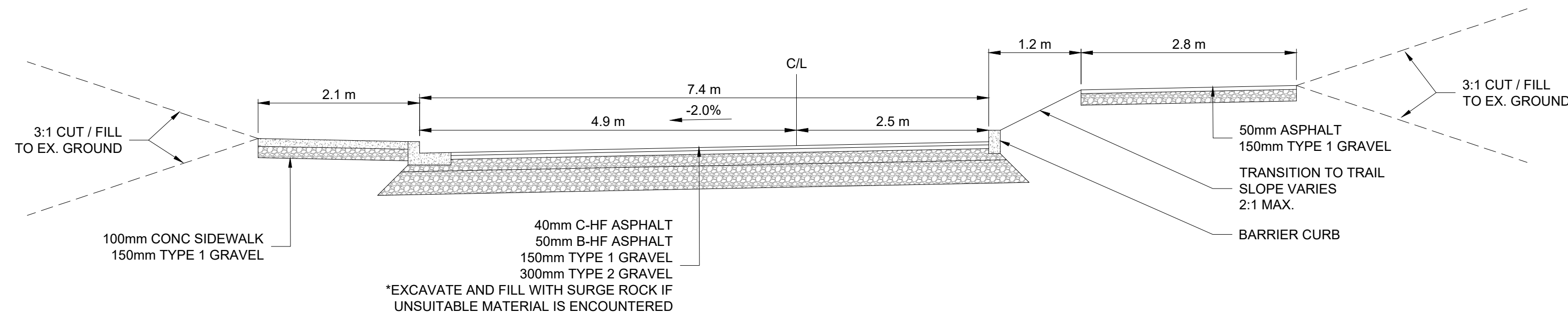

**TYPICAL ROAD SECTION - CALADH AVE WITH PARKING**

SCALE: 1:50

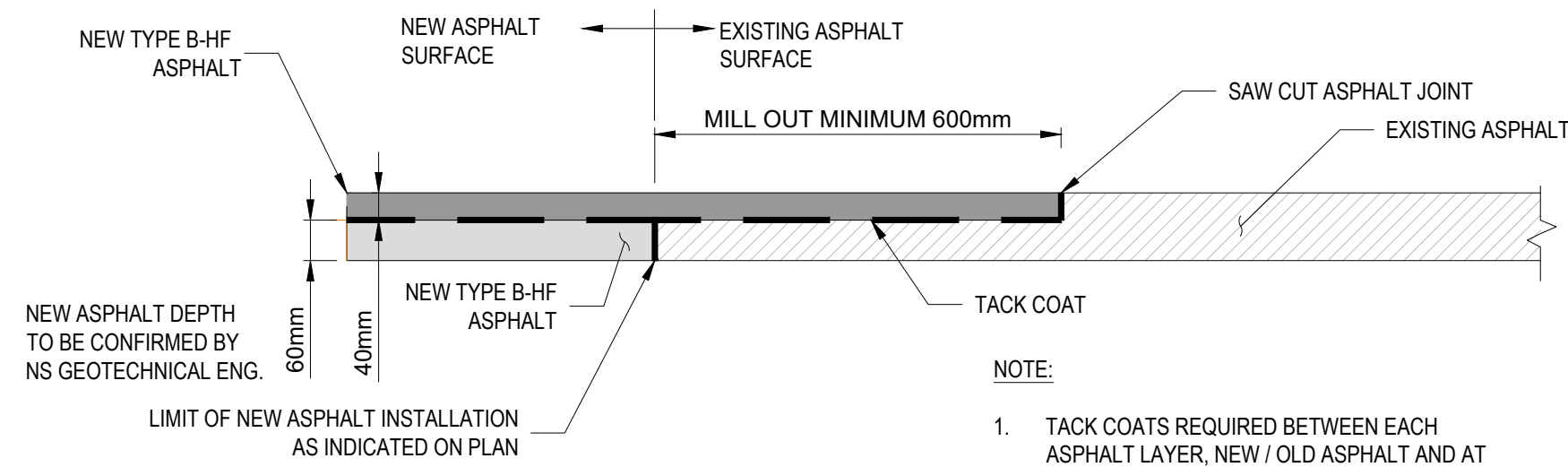

**ASPHALT JOINT TRANSITION**

SCALE: NTS

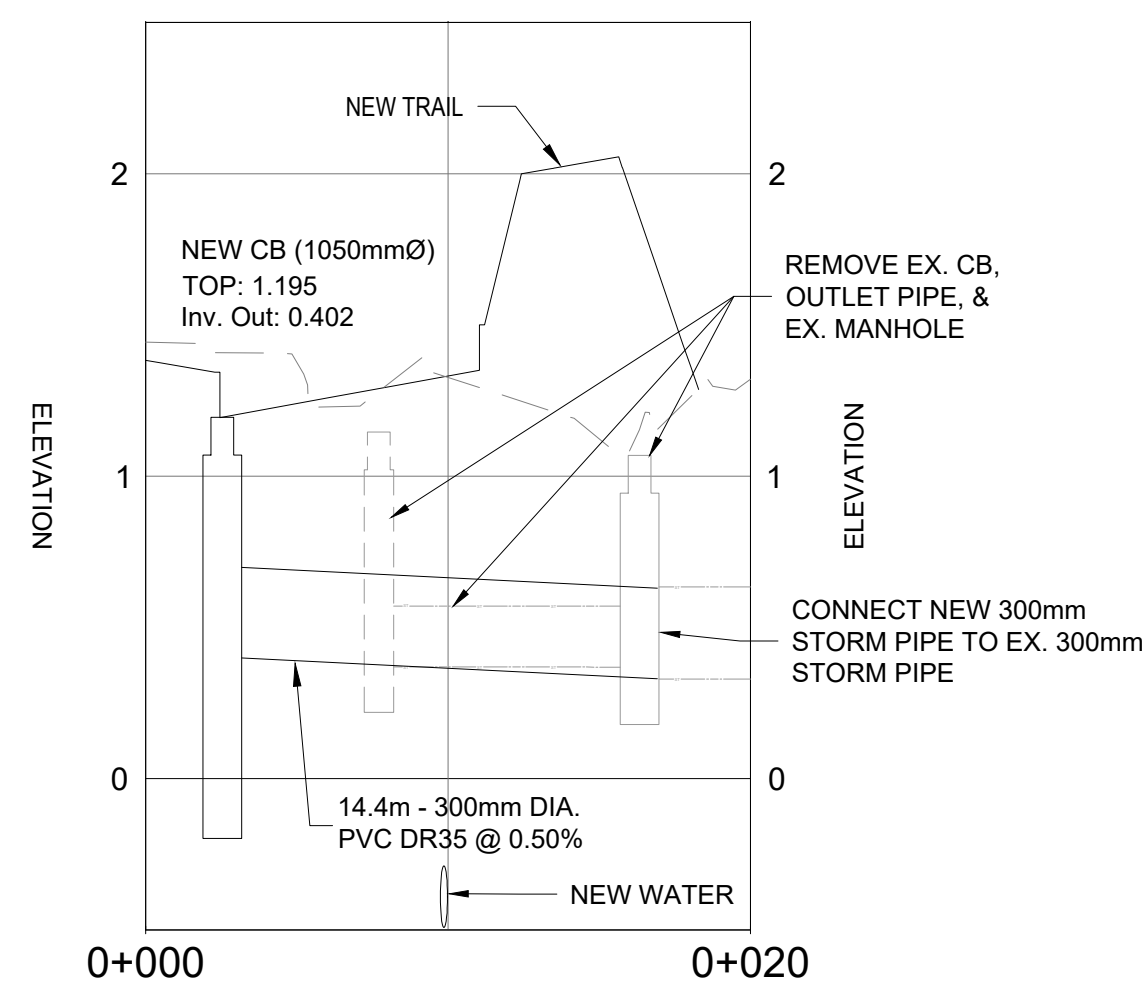

**NEW STORM PROFILE**

SCALE: 1:250

**TYPICAL DETAILS (SEE SPEC APPENDIX)**

- HRM 38 - URBAN TRAFFIC SIGN POST
- HRM 44 - URBAN SIDEWALK
- HRM 48 - CONCRETE SIDEWALK REINFORCING
- HRM 49 - PEDESTRIAN RAMP ALIGNMENT
- HRM 53 - CONCRETE CURB AND GUTTER
- HRM 61 - TRENCH BACKFILL AND REINSTATEMENT - TESTING
- HRM 90 - LONGITUDINAL AND TRANSVERSE PAVEMENT MARKINGS
- HRM 91 - PAVEMENT ARROWS
- HRM 93 - PEDESTRIAN AND TRAIL CROSSING PAVEMENT MARKINGS
- HRM 116 - ORNAMENTAL STREET LIGHT BASE
- HRM 131 - TACTILE WALKING SURFACE INDICATOR RAMP PLACEMENT
- HRM 133 - CONCRETE SIDEWALK ADJACENT CURB
- HWSD 1010 - TYP TRENCH DETAIL, WATER SYSTEM INSTALLATION ONLY
- HWSD 1030 - WATER MAIN VALVE
- HWSD 1032 - STANDARD SLIDING TYPE VALVE BOX
- HWSD 1040 - ZINC ANODE FOR VALVES AND COPPER SERVICES
- HWSD 1070 - THRUST BLOCK REQUIREMENTS
- HWSD 1080 - CONCRETE THRUST BLOCK
- HWSD 1090 - MECH. JOINT RESTRAINT REQUIREMENTS
- HWSD 1110 - HYD. INSTALLATION, URBAN STREET
- HWSD 1380 - TRACER WIRE FOR PVC WATER MAINS



NO.	DATE	REVISIONS	BY	APPR.
0	2025-01-17	ISSUED FOR 75% REVIEW	AB	GM



PROJECT TITLE  
**MARKET STREET & CALADH AVENUE RECONSTRUCTION**

PICTOU DRAWING TITLE  
NS

**GENERAL NOTES & CONSTRUCTION DETAILS**

Scale: 2.5m 0 5m (1:250 FULL SCALE)  
0.5m 0 1m (1:50 FULL SCALE)

Drawn By: AB  
Checked By: GM  
Design By: AB  
Cadd Check: JP

Sheet 6 of 6

File Name: 2402844 -1D - C01.DWG

Drawing No. C06

Y:\SHARED\CA\FREDERICKSON\FWORK\2024\2402844 - PICTOU\CALADH AVE\CADD\DESIGN\CURRENT SHEETS\2402844 -1D - C01.DWG, 16/01/2025 11:26 AM